

**Thule Urban Glide Bassinet**

# **> Instructions**



## PARTS DESCRIPTION

- A. Bassinet
- B. Foot cover
- C. Mesh Cover
- D. Left Mounting Bracket
- E. Right Mounting Bracket



## WARNING

Important – keep these instructions for future reference.

## WARNING EN 1466:2014

- Never leave child unattended.
- This product is only suitable for a child who cannot sit up unaided.
- Only use on a firm, horizontal level and dry surface.
- Do not let other children play unattended near the carry cot.
- Do not use if any part of the carry cot is broken, torn or missing.
- Only use replacement parts supplied or approved by the manufacturer.
- Carelessness causes fires! Do not use near open flame.
- The handles and the bottom of the carry cot should be inspected regularly for signs of damage and wear.
- Before carrying or lifting, make sure that the handle is in the correct position of use.
- The head of the child in the carry cot should never be lower than the body of the child.
- Do not add another mattress on top of the mattress provided or recommended by the manufacturer.

## WARNING ASTM F2050-16

- NEVER leave child unattended.
- Suffocation Hazard: Infant carrier can roll over on soft surfaces and suffocate child. NEVER place carrier on beds, sofas, or other soft surfaces.
- Fall Hazard: Child's activity can move carrier. NEVER place carrier on counter tops, tables, or any other elevated surface.
- NEVER use this carrier as a means to transport an infant in a motor vehicle.
- Read all instructions before use of the infant carrier.
- Do not use the infant carrier if it is damaged or broken.

## UNFOLDING THE THULE BASSINET



- A. To unfold, hold the bassinet on its side and squeeze the fold button and slide it to the end until you hear a "click". (See image 1)
- B. Flip the mounting adapters outwards until you hear a "click". (See image 2)
- C. Pull sunshade handle upwards until you hear a "click". (See image 3)

## FOLDING THE THULE BASSINET

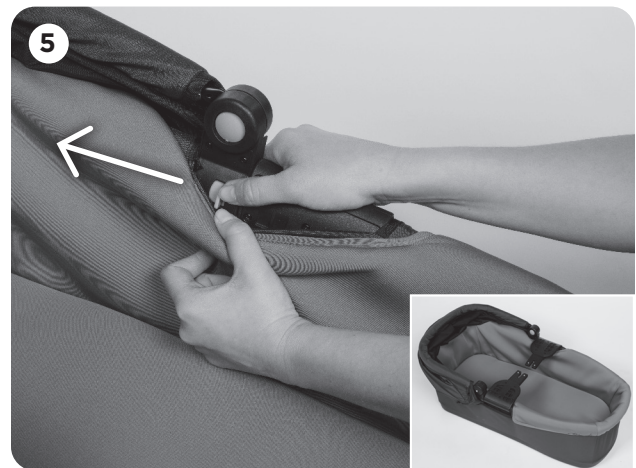

- A. To fold, press the sunshade button and lower shade. (See image 4)
- B. Slide the adapter latch forward while folding the mounting adapters inwards. (See image 5).
- C. Hold the bassinet on its side and squeeze the fold button and slide to it to the end until you hear a "click". (See image 6)

## THULE BASSINET MATRESS PAD INSTALLATION



- A. The mattress pad can be removed.
- B. When replacing the mattress pad, ensure it is in the correct direction. (See image 1)

## THULE BASSINET FOOT COVER INSTALLATION



- A. Align foot cover over the bassinet. (See image 2)
- B. Attach the toggle and the loop between the foot cover and the sunshade. (See image 3)

## THULE BASSINET MESH COVER INSTALLATION



- A. Align the rounded edge of the mesh cover with the foot side of the bassinet. (See image 1)
- B. Drape the other end of the mesh cover over the leading edge of the sunshade. (See image 2)
- C. Attach the toggle and the loop between the foot cover and the sunshade. (See image 3)
- D. The mesh cover can be used over the foot cover if desired.

## THULE BASSINET INSTALLATION FOR GLIDE 2 / URBAN GLIDE 2

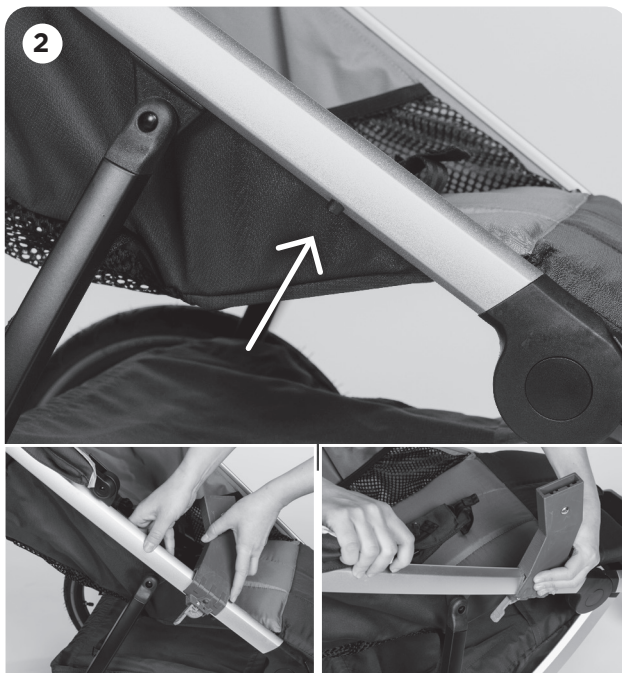
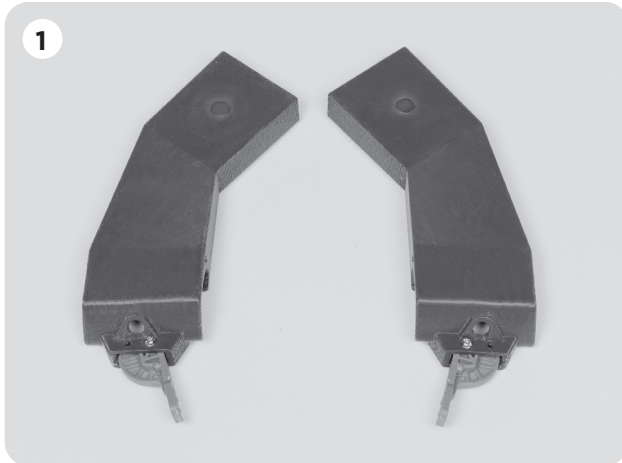

- A. Engage the parking brake on the child carrier.
- B. Open the clips on the Left and Right Mounting Brackets. (See image 1)
- C. Locate the Right Mounting Bracket to the right side of the child carrier frame by aligning the clip to the stud on the frame. (See image 2)
- D. Close the clip on the Mounting Bracket and lock the secondary lever. (See image 3)
- E. Repeat for the Left mounting Bracket on the left side of the frame.

- F. Verify that both Mounting Brackets are securely attached by giving each bracket a sharp pull away from the carrier.
- G. The bassinet must be positioned so that the child faces the stroller handlebar. Lower the bassinet onto the stroller, ensuring that the mounting adapters line up and slide into the Mounting Brackets until you hear a "click". (See image 4)
- H. Verify that the Thule Bassinet is securely attached by giving it a sharp pull away from the carrier.



### WARNING

Ensure the Mounting Brackets are aligned on the frame studs during installation.

## THULE BASSINET INSTALLATION FOR URBAN GLIDE 2 DOUBLE

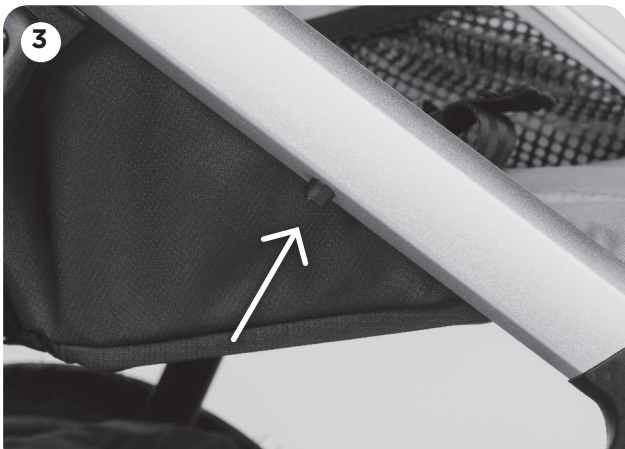
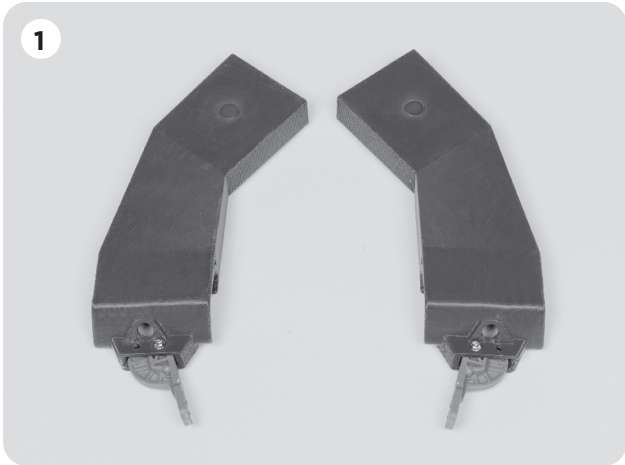

- A. Engage the parking brake on the child carrier.
- B. Open the clips on the Left and Right Mounting Brackets. (See image 1)
- C. The Thule Bassinet must be installed on the left seat (facing the carrier). (See image 2)
- D. Locate the right Mounting Bracket to the right side of the child carrier frame by aligning the clip to the stud on the frame. (See Image 3)
- E. Close the clip on the Mounting Bracket and lock the secondary lever. (See image 4)
- F. Open the velcro and zipper on the center seat divider to expose the integrated accessory adapter. (See Image 5)

Continued on next page



### WARNING

Ensure the Mounting Brackets are aligned on the frame studs during installation.



## THULE BASSINET SERVICE & CARE

- A. Examine the fabric regularly for tears, worn spots or any other signs of damage.
- B. Store your Thule Bassinet in a dry area out of direct sunlight. If possible, hang the Thule Bassinet up off of the ground. Before folding and storing your Thule bassinet, it should be dry to prevent the growth of mold or bacteria.
- C. Spot wash with mild detergent and warm water. Do not use bleach.

- G. Align the clip on the Left Mounting Bracket with the integrated accessory adapter, ensuring the fabric is not underneath the adapter. (See Image 6)
- H. Close the clip on the Mounting Bracket and lock the secondary lever. Close the Velcro.
- I. Verify that both Mounting Brackets are securely attached by giving each bracket a sharp pull away from the carrier.
- J. The bassinet must be positioned so that the child faces the stroller handlebar. Lower the bassinet onto the stroller, ensuring that the adapters line up and slide into the Mounting Brackets until you hear a "click". (See image 7)
- K. Verify that the Thule Bassinet is securely attached by giving the bassinet a sharp pull away from the carrier.

 Thule Canada Inc.  
105 - 5760 9th Street SE Calgary, AB T2H 1Z9 Canada

 [info@thule.com](mailto:info@thule.com)

 [www.thule.com](http://www.thule.com)

» PART OF THULE GROUP